

# AIR GUN & TRANSFER TUBE

## EXAIR®



SMALL VOLUME OF COMPRESSED AIR  
PRODUCE LARGE VOLUME OF AIR.

- Suction/Discharge are convertible.
- Tube(air transfer tube)can be replaced.
- Volume of flowing air is adjustable.
- Employment of valve-cam mechanism makes operation of switch smooth.

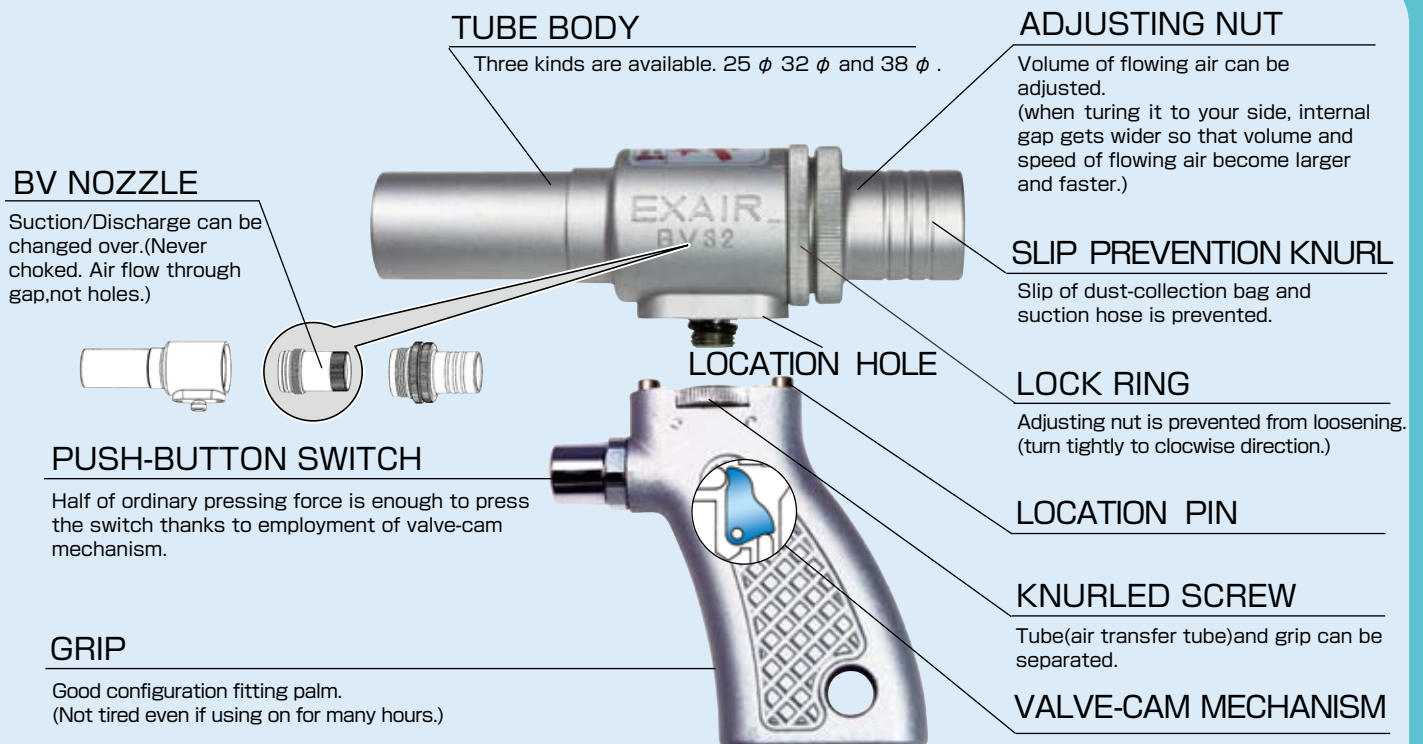

BLOVAC CO.,LTD.

EXAIR GUN & TUBE are air guns and transfer tubes that can easily and powerfully perform such works as suction, blow-off and transfer using compressed air as power source. Its inner part is cylindrical and no obstacle inside. Therefore, there is no possibility that the sucked or transferred object may choke it. In addition, no trouble caused by wear because of no rotating parts. Furthermore, new features that the transfer tubes can be replaced and the volume of flowing air is adjustable are equipped.

## EXAIR GUN ★ 5 FUNCTIONS ● Air blow ● Suction ● Transfer ● Cooling ● Drier



MODEL BV32

● SUCTION/DISCHARGE are convertible by means of changing the direction of BV nozzle.

★ TUBE(TRANSFER TUBE)AND GRIP CAN BE SEPARATED. SELECT THE TUBE DIA.( $\phi 25$ ,  $\phi 32$ ,  $\phi 38$ )ACCORDING TO THE SIZE AND VOLUME OF THE SUCKED OBJECT.

	OVERALL LENGTH	O.D.	MINI. I.D.	AIR HOSE DIA	MATERIAL
<b>BV25</b>	169.1	$\phi 25$	$\phi 15$	PT 1 / 4	Aluminium
<b>BV32</b>	169.1	$\phi 32$	$\phi 22$	PT 1 / 4	Aluminium
<b>BV38</b>	169.1	$\phi 38$	$\phi 28$	PT 1 / 4	Aluminium

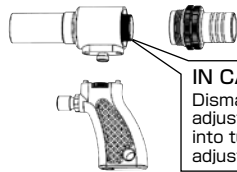

**IN CASE OF DISCHARGE**  
Dismantle BV nozzle from adjusting nut. Screw it deeply into tube body and then set adjusting nut.

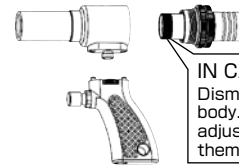

**IN CASE OF SUCTION**  
Dismantle BV nozzle from tube body. Screw it deeply into adjusting nut and then install them on tube body.

## EXAIR TUBE ● LOW COST ● COMPACT ● MAINTENANCE FREE



MODEL T32

★ APPLICABLE TO VARIETY OF DEVICES, EQUIPMENT, LINES.

Flow adjusting function is equipped so that pressure adjustment by regulators is not necessary. Air consumption can be saved by ON/OFF control of magnetic valve.

- Cutting chips of metal and wood, oil smoke and dust can be efficiently eliminated by installing near their source.
- Applicable as transfer device by installing on the supply device of material and parts.
- Applicable as cooling device for hardened works and drier for liquid-cleaned parts.

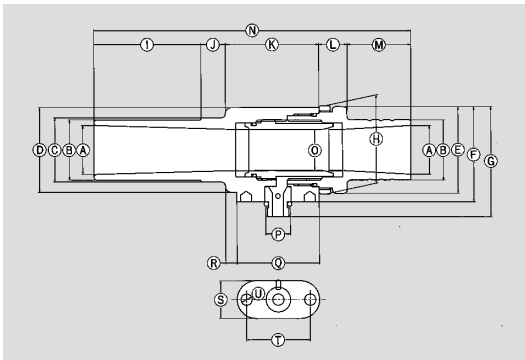

S type <With hose joint>

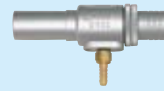

L type <With universal elbow+hose joint>



SV type <With valve+hose joint>

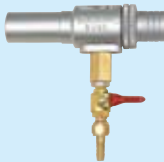

LV type <With universal elbow+valve+joint>

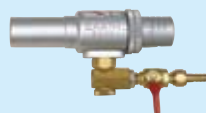

★ UNIVERSAL ELBOW: Direction of air inlet can be freely changed in 360°

### ■ DIMENSIONS (mm)

	A	B	C	D	E	F	G	H	I	J	K	L	M	N	O	P	Q	R	S	T	U
<b>T25</b>	19	25	27	38	39	43.5	51.5	40	57	13	50	15.1	34	169.1	15	PT1/4	44	6	20	34	$\phi 6$
<b>T32</b>	26	32	34	45	46	50.5	58.5	47	57	13	50	15.1	34	169.1	22	PT1/4	44	6	20	34	$\phi 6$
<b>T38</b>	32	38	40	51	52	56.5	64.5	53	57	13	50	15.1	34	169.1	28	PT1/4	44	6	20	34	$\phi 6$



GUN(TUBE), NOZZLE, DUST BAG, HOSE BAND(1)

AIR CONSUMPTION VOLUME (L/min) < at 5kg/cm<sup>2</sup> >

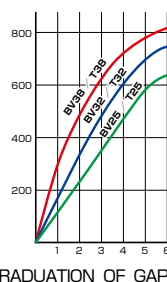

DEGREE OF VACUUM (mmAq) < at 5kg/cm<sup>2</sup> >

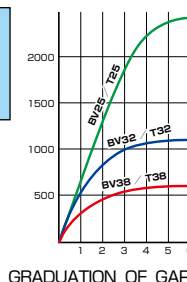

AIR SUCTION VOLUME (L/min) < at 5kg/cm<sup>2</sup> >

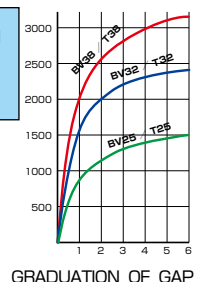

Manufactured By

**BLOVAC CO.,LTD.** <http://www.blovac.com> E-mail : [info@blovac.com](mailto:info@blovac.com)

Head Office / 1-1-20-107, Azabudai, Minato-ku, Tokyo 106-0041, Japan Tel. + 81-3-3586-6341 / Fax. + 81-3-3582-4463

Factory / 1053, Fujiwarada, Ueda-shi, Nagano 386-0402, Japan Tel. + 81-268-67-2523 / Fax. + 81-268-67-2284